

FLAMEPROOF

ECR-3 - Drain valve



- Drain valve ECR3 is a device intended for use to evacuate the water generated due to condensation inside the enclosure.
 - Drain valve is assembled in the lowest part or side part of the enclosure because the water is accumulated in bottom part of enclosure.
 - Water will come out with the presence of drain valve device.
 - Made of stainless steel or galvanized steel.
 - Gasket is in aluminium.
 - O-ring is in silicon rubber.
 - IP66/IP67 in closed position (IP44 when installed on the bottom or on the side of enclosure*)
- *for detail see instruction note

TECHNICAL FEATURES

Material	Stainless steel AISI 316 L
IP rating	IP66/IP67 in closed position and IP44 in open position.
Ambient temperature range	-50°C +105°C
Approvals	ATEX: IMQ 14 ATEX 019U – IECEx: IMQ 14.0008U - EAC: RU C-IT.BH02.B.00593/20
Marking	Ex II 2GD – Ex e IIC Gb – Ex tb IIIC IP66/67
Standard compliance	EN60079-0:2012; EN60079-7:2007; EN60079-31:2009 IEC60079-0:2011; IEC60079-7:2006-07; IEC60079-31:2008
Zones	1; 21
Gaskets	Silicone gasket (continuous use temperature -60 ° C + 220 ° C)
Entries	Need to hole M16 x 1.5 6H or diameter from 16 mm to 16.5 mm and seal metal aluminum EN-AW 1050.

Dimensions ECR-3

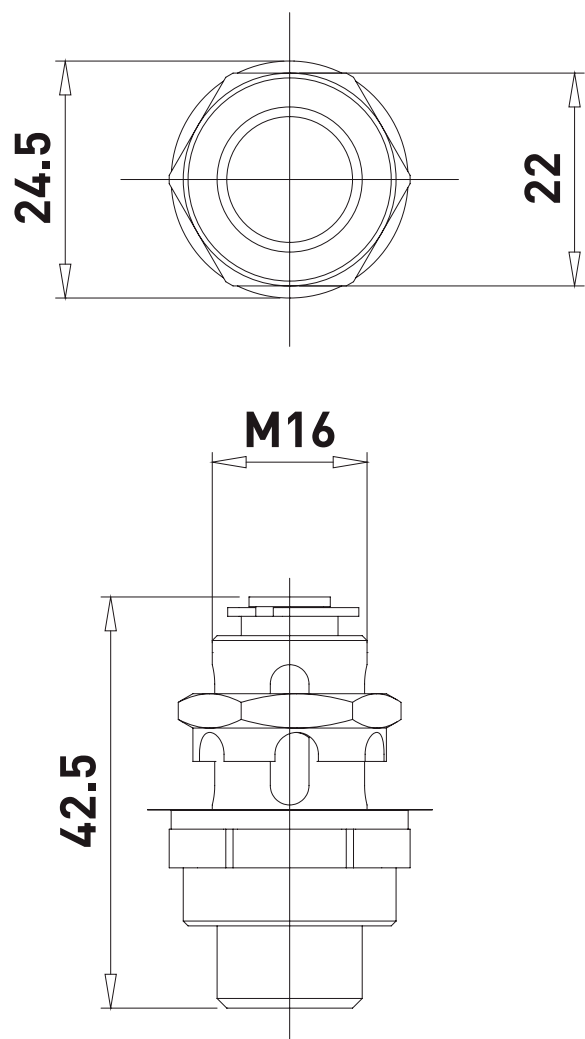

Drain valve ECR-3

CODE	TYPE
B080909000006	ECR 3 DRAIN VALVE